



Comhairle Chontae Na Mí
Meath County Council

BOHERMEEN SEWERAGE SCHEME
OUTFALL LICENCE APPLICATION

4654/OL/05/00	Schedule of Drawings
4654/OL/05/01	Attachment A.1 - Site Location Map
4654/OL/05/02	Attachment B.1 - Agglomeration Outline Plan
4654/OL/05/03	Attachment B.2 - Existing Waste Water Treatment Facilities - Overall Site Plan
4654/OL/05/04	Attachment B.3 - Existing Primary Discharge Point
4654/OL/05/05	Attachment C.1 - Existing Waste Water Treatment Facilities - Layout Plan
4654/OL/05/06	Attachment F.1 - Designation Map

For inspection purposes only
Consent of copyright owner required for any other use

Notes

1. FIGURED DIMENSIONS ONLY TO BE TAKEN FROM THIS DRAWING
2. ALL DRAWINGS TO BE CHECKED BY THE CONTRACTOR ON SITE.
3. ENGINEER TO BE INFORMED OF ANY DISCREPANCIES BEFORE ANY WORK COMMENCES.

rev.	modifications	by	ds

client	MEATH COUNTY COUNCIL		
project	BOHERMEEN SEWERAGE SCHEME		
stage	WASTE WATER DISCHARGE LICENCE APPLICATION		
title	SCHEDULE OF DRAWINGS		
scales	N/A		
drawn	checked	approved	date
TC	YMcG	TMcG	Nov 2009

© COPYRIGHT OF
JENNINGS O'DONOVAN & PARTNERS
CONSULTING ENGINEERS,
FINISKLIN BUSINESS PARK,
SLIGO.
Tel: (071) 9161416.
Fax: (071) 9161080.
Email: info@jodireland.com



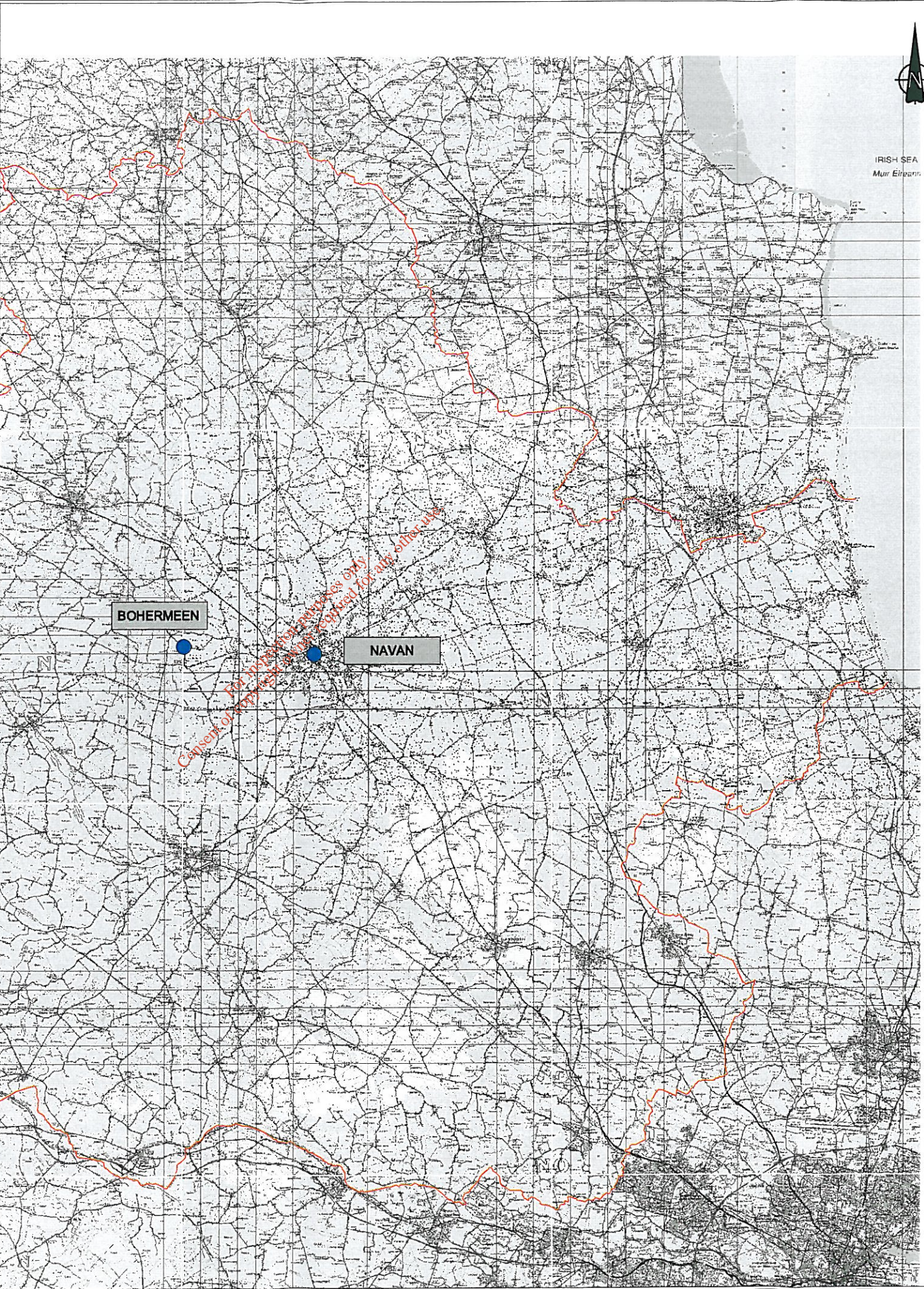
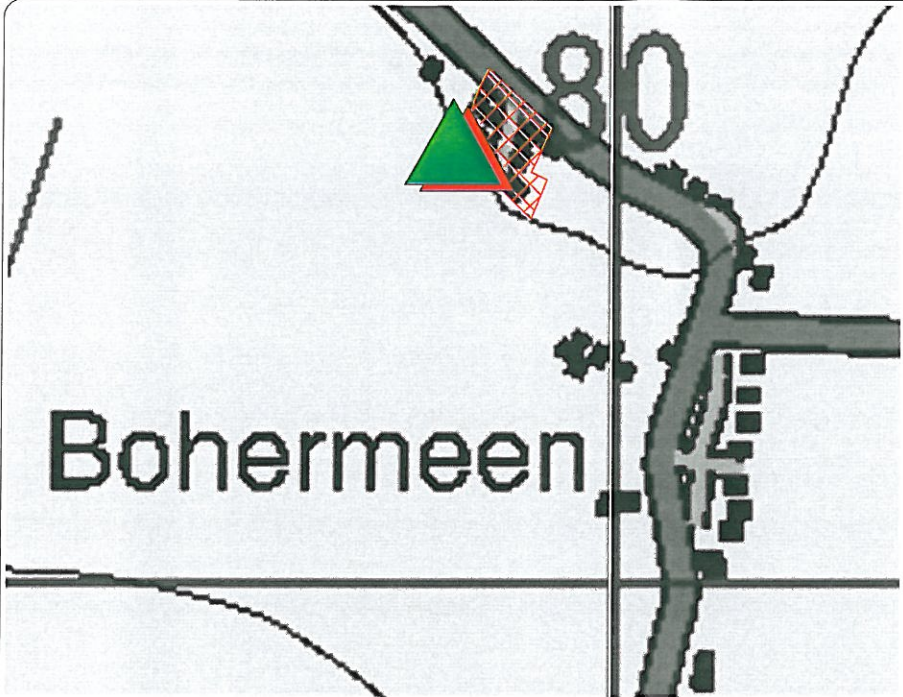

drawing no.	revision
4654/OL/05/00	



Notes

1. FIGURED DIMENSIONS ONLY TO BE TAKEN FROM THIS DRAWING.
2. ALL DRAWINGS TO BE CHECKED BY THE CONTRACTOR ON SITE.
3. ENGINEER TO BE INFORMED OF ANY DISCREPANCIES BEFORE ANY WORK COMMENCES.

LEGEND :

-  AGGLOMERATION CATCHMENT AREA
-  EXISTING TREATMENT WORKS
-  EXISTING TREATED EFFLUENT DISCHARGE POINT

rev.	modifications	by	date

client	MEATH COUNTY COUNCIL		
project	BOHERMEEN SEWERAGE SCHEME		
stage	WASTE WATER DISCHARGE LICENCE APPLICATION		
title	ATTACHMENT A.1 LOCATION MAP		
scales	1 / 10,000 & 1 / 250,000		
drawn	checked	approved	date
C	YMcG	TMcG	Nov. 2009

© COPYRIGHT OF
JENNINGS O'DONOVAN & PARTNERS
CONSULTING ENGINEERS,
FINISKLIN BUSINESS PARK,
SLIGO.
Tel. (071) 9161416.
Fax. (071) 9161080.
Email info@jodireland.com



drawing no.	revision
4654/OL/05/01	



- Notes**
- 1. FIGURED DIMENSIONS ONLY TO BE TAKEN FROM THIS DRAWING
 - 2. ALL DRAWINGS TO BE CHECKED BY THE CONTRACTOR ON SITE
 - 3. ENGINEER TO BE INFORMED OF ANY DISCREPANCIES BEFORE ANY WORK COMMENCES.

LEGEND :

- Agglomeration Catchment Area
- Existing Sewers
- Existing Works

rev.	modifications	by	da

client			
MEATH COUNTY COUNCIL			
project			
BOHERMEEN SEWERAGE SCHEME			
stage			
WASTE WATER DISCHARGE LICENCE APPLICATION			
title			
ATTACHMENT B.1 AGGLOMERATION OUTLINE PLAN			
scales			
1 / 1,000			
drawn	checked	approved	date
TC	YMcG	TMcG	Nov. 2009

© COPYRIGHT OF
JENNINGS O'DONOVAN & PARTNERS
CONSULTING ENGINEERS,
FINISKLIN BUSINESS PARK,
SLIGO.
Tel. (071) 9161416.
Fax. (071) 9161080.
Email info@jodireland.com



drawing no.	revision
4654/OL/05/02	

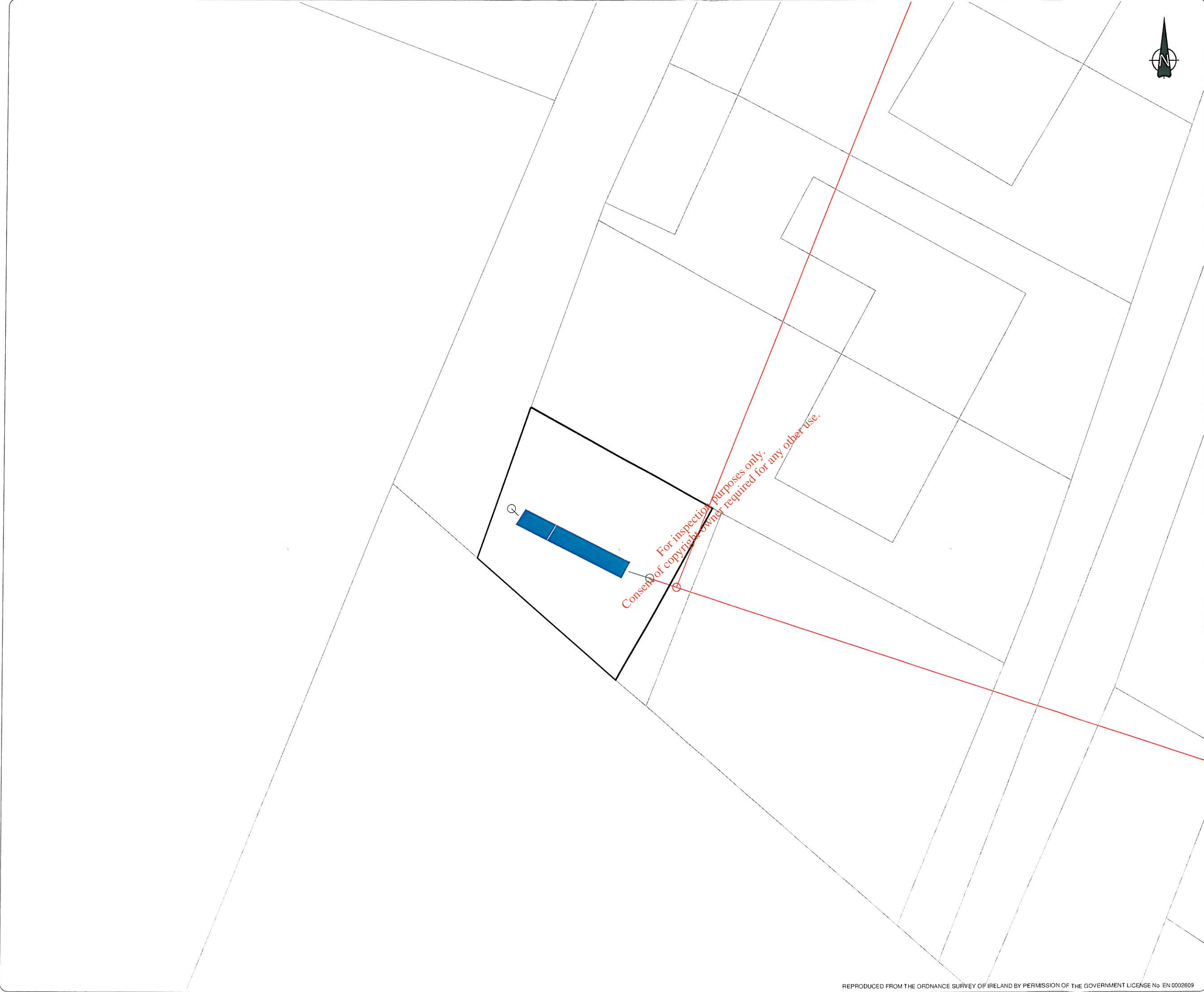

- Notes
- 1. FIGURED DIMENSIONS ONLY TO BE TAKEN FROM THIS DRAWING
 - 2. ALL DRAWINGS TO BE CHECKED BY THE CONTRACTOR ON SITE
 - 3. ENGINEER TO BE INFORMED OF ANY DISCREPANCIES BEFORE ANY WORK COMMENCES.

rev	modifications		by	ds

client			
MEATH COUNTY COUNCIL			
project			
BOHERMEEN SEWERAGE SCHEME			
stage			
WASTE WATER DISCHARGE LICENCE APPLICATION			
title			
ATTACHMENT B.2 EXISTING WASTE WATER TREATMENT FACILITIES OVERALL SITE PLAN			
scales			
1 / 250			
drawn	checked	approved	date
TC	YMcG	TMcG	Nov. 2009

© COPYRIGHT OF
JENNINGS O'DONOVAN & PARTNERS
CONSULTING ENGINEERS,
FINISKILIN BUSINESS PARK,
SLIGO.
Tel. (071) 9161416.
Fax. (071) 9161080.
Email info@jodireland.com

drawing no.	revision
4654/OL/05/03	



Notes

1. FIGURED DIMENSIONS ONLY TO BE TAKEN FROM THIS DRAWING
2. ALL DRAWINGS TO BE CHECKED BY THE CONTRACTOR ON SITE
3. ENGINEER TO BE INFORMED OF ANY DISCREPANCIES BEFORE ANY WORK COMMENCES.

LEGEND :

- Existing Foul Sewers
- Existing Works
- Existing Primary Discharge Point

SW1(P) - EXISTING / PROPOSED
PRIMARY DISCHARGE POINT
279841 EAST
268436 NORTH

EXISTING WASTE WATER
TREATMENT WORKS

For inspection purposes only.
Consent of copyright owner required for any other use.

Bohe

79.9

78.5

client	MEATH COUNTY COUNCIL		
project	BOHERMEEN SEWERAGE SCHEME		
stage	WASTE WATER DISCHARGE LICENCE APPLICATION		
title	ATTACHMENT B.3 EXISTING PRIMARY DISCHARGE POINT OVERALL SITE PLAN		
scales	1 / 1,250		
drawn	checked	approved	date
TC	YMcG	TMcG	Nov 2009

© COPYRIGHT OF
JENNINGS O'DONOVAN & PARTNERS
CONSULTING ENGINEERS,
FINISKLIN BUSINESS PARK,
SLIGO.
Tel. (071) 9161415
Fax. (071) 9161080.
Email info@jodireland.com



drawing no.	revision
4654/OL/05/04	



- Notes
1. FIGURED DIMENSIONS ONLY TO BE TAKEN FROM THIS DRAWING
 2. ALL DRAWINGS TO BE CHECKED BY THE CONTRACTOR ON SITE
 3. ENGINEER TO BE INFORMED OF ANY DISCREPANCIES BEFORE ANY WORK COMMENCES.

rev	modifications	by	ds

client	MEATH COUNTY COUNCIL		
project	BOHERMEEN SEWERAGE SCHEME		
stage	WASTE WATER DISCHARGE LICENCE APPLICATION		
title	ATTACHMENT C.1 EXISTING WASTE WATER TREATMENT FACILITIES LAYOUT PLAN		
scales	1 / 100		
drawn	checked	approved	date
TC	YMcG	TMcG	Nov 2009

© COPYRIGHT OF
JENNINGS O'DONOVAN & PARTNERS
CONSULTING ENGINEERS,
FINISKLIN BUSINESS PARK,
SLIGO.
Tel. (071) 9161416.
Fax. (071) 9161080.
Email info@jodireland.com



drawing no.	revision
4654/OL/05/05	



NOTES
Figured dimensions only to be taken from this drawing
All dimensions to be checked on site.

All Levels are in Metres and Relate to O.S. Datum Malin
All Maps are Referenced to Irish National Grid (I.N.G.)
Ordnance Survey of Ireland Licence No.EN 0002609
© Government of Ireland

Key Map Features

- Waste Water Treatment Plant
- Primary Discharge Point
- ▨ pNHA / NHA
- ▨ SAC
- ▨ SPA

Rev: Description: Drawn: Ch'kd: Date:

Client:

MEATH COUNTY COUNCIL

Client Representative:



Project: **Waste Water Discharge
Certificate Authorisation**

Drawing Title:

**Bohermeen
Attachment F.1
Designation Map**

Drawn By: T.C Date: December 09

Checked By: Y.McM Date: December 09

Stage: Waste Water Discharge Certificate

Scales: N.T.S.

Drawing No. 4654/OL/05/06 Revision: